

E-Newsletter – 8th January 2021

www.bera.co.uk



© Andrew Armstrong Photography

1) Information Corner

The Broadway Flooding – 7th January

The gully cleansing crew cleared the gully of the standing water.

The position on the affected gully is literally at the base of the tree. However, there was very little evidence of tree roots in the gully itself, other than some fibrous roots underneath the gully frame.

Following the gully being emptied, it was filled back up again to ascertain if flow was moving, to which it was found to be very. Therefore, the issue may be further afield in either the outlet pipe to the mains or the mains itself. Unfortunately, no jetting of the outlet pipe could be carried out due to the 'swan neck' construction present on the outlet pipe which wouldn't allow the jetter to pass.

The term contractor have been asked to price and programme a specific jetting and CCTV survey of said gully/outlet pipe to ascertain its condition and whether this is the cause of the flooding.

A further update will be provided once the investigation has been carried out.

£50m investment proposed for pavements and roads over the next five years

A major increase in investment into local pavements and roads is being proposed as part of the council's capital investment programme for 2021 to 2026.

The councillor responsible for highways has called the proposed £50m investment over the next five years a 'game-changer' for residents and drivers across the Borough.

Significant new investment of £21m is being proposed up to 2025/26 in the capital investment programme, including £14m for pavements and £7m for road improvements. A further £29m, made up of £19m for pavements and £10m for roads will be invested subject to being affordable and deliverable.

Together this would represent an average investment of £10m a year into highway improvements over the next five years, a significant increase on the average of £1.6m a year invested in highways over the last five years.

Cllr Ron Woodley, deputy leader of the council, says: "For many years there has been underinvestment into our pavements and roads, and last year we added funding to that budget.

"However, it was still not enough, and so I am delighted to propose a game changing step change in how we much we invest into pavements and roads. Over the next five years we will spend £50m resurfacing more roads and pavements and filling more potholes and issues where full resurfacing is not required.

"We know from developing our Southend 2050 ambition that this is one of the most important issues for local people, and I am pleased to be delivering against our promise to deal with this. If approved this additional investment will be seen across the Borough and will see major improvements to those roads and pavements that are most in need of repair or full resurfacing."

This is in addition to the combined budget of £3million already in the approved capital investment programme in 2020/21 for roads and pavements targeted at some of the highest priority pavements and roads that need repair, across a range of wards.

£4.6m is also included in the programme for highways infrastructure schemes including highways protection at Belton Way and bridge strengthening works funded by grants received from the Department for Transport, along with £0.8m for resurfacing Alexandra Street, Clarence Road, Hamlet Court, Warrior Square and Fairheads Green car parks.

The draft budget will be considered by the council's cabinet on Thursday 14th January, the council's three scrutiny committees at the start of February, with the final budget to be considered at Full Council on Thursday 25th February.

Seafont car parks closed – Don't Visit Southend

Southend-on-Sea Borough Council is urging local people to stay at home and visitors to stay away to help protect lives and to protect the NHS following an exponential rise in positive Coronavirus cases.

In the early hours of Wednesday morning (30 December), the Essex Resilience Forum (ERF) – which is made up of local authorities, emergency services and the

NHS – announced a major critical incident across Essex as hospital admissions and positive cases continue to rise across the county. Positive cases across the Borough also continue to rise rapidly.

Within the existing Tier 4 Government restrictions, people should stay home, and although allowed to leave their homes for essential shopping and for exercise, should stay local. However, over the last few days there has been a huge increase in the number of people visiting the seafront, including large numbers of people from outside the Borough.

As the local health service is facing unprecedented challenges with the exponential rise in positive Coronavirus cases, the council is taking measures to prevent large crowds gathering in visitor hotspots, particularly the seafront. With this in mind, and with large numbers expected to be out on walks over the new year period, the council will be closing all seafront car parks, along with suspending all seafront parking spaces from Wednesday 30 December. This will be regularly reviewed and clearly signed. Additionally, the cinder path between Chalkwell and Leigh will be closed.

A list of closed car parks and suspended parking bays are as follows:

Belton Bridge bays
Belton Gardens South car park
Belton Gardens North car park
Chalkwell Esplanade bays
Eastern Esplanade bays
Fairheads Green car park
Gas Works car park
Ness Road bays
Seaway car park
Shoebury Common North car park
Shoebury Common South car park
Shoebury East Beach car park
Thorpe Esplanade bays
Thorpe Esplanade car park
Victoria Wharf car park
Western Esplanade bays
Leigh Foundry car park

Stay safe Southend – stay at home, protect the NHS, save lives

As the country enters a national lockdown, councillors are pleading with local people to adhere to the regulations, stay at home, and look out for their friends and neighbours.

The Prime Minister announced a national lockdown last night which means you must not leave, or be outside of your home except where necessary. You may leave your home to:

- shop for basic necessities, for you or a vulnerable person

- to go to work if you cannot reasonably do so from home
- to exercise with your household (or support bubble) or one other person. This should be limited to once per day, and you should not travel outside your local area
- meet your support bubble or childcare bubble where necessary, but only if you are legally permitted to form one
- seek medical assistance or avoid injury, illness or risk of harm (including domestic abuse)
- attend education or childcare - for those eligible

In addition, you cannot leave your home to meet socially with anyone you do not live with or are not in a support bubble with, and you should not meet other people you do not live with, or have formed a support bubble with, unless for a permitted reason.

People should also stay safe by staying 2m apart from anyone not in their household, and continuing to wash their hands regularly and wearing a face covering.

For more information on a range of support available in the community, please visit the Livewell Southend website.

On Wednesday 30 December, the council announced that it was suspending seafront car parks and parking bays in order to deter visitors from travelling into the Borough.

‘Buy one get one free’ junk food to be banned in 2022

“Buy one, get one free” offers on unhealthy food will be banned from April 2022, the Government has confirmed.

Tooth decay in children

Dentists are calling on the Government to tackle a “national scandal” which has seen more than 33,000 children a year have such rotten teeth that they have to be surgically removed. According to the Local Government Association, the most common reason for a child to attend a hospital between the ages of six and nine is to have their teeth out.

APPEALS BULLETIN FOR 1 Sept – 31 Dec 2020

Application Ref. No
Location

20/00731/FULH
64 Canterbury Avenue
Southend-On-Sea Essex SS2 4QL

Proposal	Erect two storey side extension and alter elevations (Part Retrospective) (Amended Proposal)
Date Lodged	09.11.20
Officer Dealing	Julie Ramsey
Comments Due Date	As this is a Householder appeal, this is not applicable
Ward	Southchurch
Application Ref.No	20/00800/FUL
Location	2 Coptfold Close Southend-On-Sea Essex SS1 3SY
Proposal	Convert dwelling house into two self contained flats, erect part single/two storey side extension, erect part single/part two storey rear extension, alter elevations, layout parking to front
Date Lodged	14.12.20
Officer Dealing	Spyros Mouratidis
Comments Due Date	18.01.21
Ward	Southchurch
Application Ref.No	20/00950/FULH
Location	6 Philpott Avenue Southend-On-Sea Essex SS2 4RL
Proposal	Erect single storey side extension
Date Lodged	31.12.20
Officer Dealing	Oliver Hart
Comments Due Date	As this is a Householder appeal, this is not applicable
Ward	Southchurch
Application Ref.No	20/01129/FULH
Location	175 Maplin Way Thorpe Bay Essex SS1 3NE
Proposal	Erect single storey side and rear extension, install rooflights, alter elevations
Date Lodged	25.11.20
Officer Dealing	Kara Elliott
Comments Due Date	As this is a Householder appeal, this is not applicable
Ward	Thorpe
Application Ref.No	20/00782/FULH
Location	79 Lifstan Way Southend-On-Sea Essex SS1 2XQ

Proposal	Erect single storey rear extension
Date Lodged	25.11.20
Officer Dealing	Kara Elliott
Comments Due Date	As this is a Householder appeal, this is not applicable
Ward	Thorpe
Application Ref.No	20/00537/FULH
Location	472 Woodgrange Drive Southend-On-Sea Essex SS1 3ED
Proposal	Erect single storey rear extension (Amended Proposal)
Date Lodged	26.11.20
Officer Dealing	Kara Elliott
Comments Due Date	As this is a Householder appeal, this is not applicable
Ward	Thorpe
Application Ref.No	20/00378/FUL
Location	97-99 And 100 Shaftesbury Avenue Southend-On-Sea Essex SS1 3AN
Proposal	Erect single storey building and part change of use of domestic garden at 101 Shaftesbury Avenue for use as tea/coffee shop (Class A3) and ancillary refuse and cycle storage, and external seating area with boundary treatments
Date Lodged	11.12.20
Officer Dealing	Robert Lilburn
Comments Due Date	15.01.21
Ward	Thorpe
Application Ref.No	20/01019/FULH
Location	67 Thorpedene Gardens Shoeburyness Southend-On-Sea Essex SS3 9JE
Proposal	Erect hipped to gable roof extension and dormer to rear to form habitable accommodation in the roofspace, erect single storey extensions to side and rear with roof lantern to rear
Date Lodged	10.12.20
Officer Dealing	Oliver Hart
Comments Due Date	As this is a Householder appeal, this is not applicable 15.12.20
Ward	West Shoebury

APPEALS DETERMINED

Application Ref.No 20/00731/FULH
 Location **64 Canterbury Avenue Southend-On-Sea Essex SS2 4QL**
 Proposal Erect two storey side extension and alter elevations (Part Retrospective) (Amended Proposal)
 Appeal Decision Appeal Dismissed
 Date of Decision 14.12.20
 Ward **Southchurch**

Application Ref.No 19/01840/FULH
 Location **472 Woodgrange Drive Southend-On-Sea Essex SS1 3ED**
 Proposal Erect single storey rear extension (Amended Proposal)
 Appeal Decision Appeal Dismissed
 Date of Decision 19.10.20
 Ward **Thorpe**

Application Ref.No 19/01961/FULH
 Location **31 Fermoy Road Thorpe Bay Essex SS1 3HA**
 Proposal Erect single storey rear extension and raised terrace to rear
 Appeal Decision Appeal Dismissed
 Date of Decision 14.10.20
 Ward **Thorpe**

Application Ref.No 19/02213/FULH
 Location **48 Chelsworth Crescent Thorpe Bay Essex SS1 3EF**
 Proposal Erect single storey side extension (retrospective)
 Appeal Decision Appeal Allowed
 Date of Decision 19.10.20
 Ward **Thorpe**

Application Ref.No 20/00129/FUL
 Location **207A Eastern Esplanade Southend-On-Sea Essex SS1 3AD**

Proposal Erect dormers to front and rear and convert loft into habitable accommodation, install balcony to second floor front and alter elevations (Amended Proposal)
Appeal Decision Appeal Dismissed
Date of Decision 01.10.20
Ward **Thorpe**

Application Ref.No 19/01997/FULH
Location **22 Hayes Barton Shoeburyness Southend-On-Sea Essex SS1 3TS**
Proposal Erect two storey front extensions and new front porch and glazed landing, alter roof form by extending width of main roof, install new flat roof and pitched roof to the front and part gabled, part hipped roof extension to side, remove existing dormers to side and install new dormer and window to side, convert roof space into habitable accommodation and alter elevations (Amended Proposal)
Appeal Decision Appeal Dismissed
Date of Decision 16.10.20
Ward **West Shoebury**

Draft council budget focused on investments into key projects and services

More investment into caring for our most vulnerable children and adults, local housing, economic recovery, the green agenda, and a major focus on fixing pavements and roads are at the centre of the council's proposed budget for 2021/22.

Despite the Government suggesting in the local finance settlement that councils raise council tax by 5%, cabinet councillors will consider increasing council tax by 1.99%, with a further 2% for adult social care (3.99% in total).

The proposed rise is 73p for a Band A home, 86p for Band B, 98p a week for Band C and £1.10 for Band D* and will help protect frontline services, fund an extra £3.6m to meet additional demand in children's and adult social care services, including £590,000 for looked after children, £150,000 to help drive the recruitment of local foster carers and £25,000 for the reintroduction of a small school uniform grant for eligible children under exceptional circumstances.

Savings and new income will raise £4.15m and £2.5m of reserves will be used to set a balanced net base budget of £133.42m for 2021/22. The council will also need to meet an expected budget gap of a further £20.4m up to 2026.

It is also proposed that £21m is added to the council's main capital investment programme and a further £29m to be added subject to being affordable and

deliverable, making an ambitious but realistic and deliverable investment programme of £169m from 2021 to 2026. This includes £53 million investment for the Housing Revenue Account (HRA) that will be used to improve council homes in the Borough over the next five years and continue to deliver new affordable council housing.

Meanwhile, car parking charges from 1 April 2021 will be simplified, with zones introduced, and some charges increasing along the central seafront but decreasing in other areas across the Borough. These changes coincide with the introduction of the Southend Pass, which will allow local residents to park for 3 hours in any zone for just 28p a day or £8.50 a month.

For the first time ever, the council's tax base, the figure used to calculate the council's revenue budget has decreased due to the impact of COVID-19 and associated council tax support required.

This follows on from many years of Government cuts, which has seen the main grant the council receives from Government reduce from £64m in April 2011 to an estimated £6.1m in April 2021, a cut of around 90%. The main Government grant received next year will therefore only account for 4.45% of the council's net budget, as opposed to 50% in 2011.

Within the investment and savings proposals there is the creation of 29 full time equivalent (FTE) posts and the proposed deletion of approximately 38 FTE posts.

The Council's policies on managing organisational change, redeployment and redundancy will be followed accordingly. Consultations with staff and Trade Unions will continue throughout the budget development and implementation process.

The draft budget will be considered by the council's cabinet on Thursday 14th January, the council's three scrutiny committees at the start of February, with the final budget to be considered at Full Council on Thursday 25th February.

Possible Scams

a) Scammers target people with COVID-19 vaccine fraud

Scammers are reportedly using the rollout of the NHS COVID-19 vaccine to target people with fraudulent text messages which asks people to hand over their bank details. The Local Government Association said some councils have recorded a 40 per cent increase in reported scams since the start of the COVID-19 emergency, with officers continuing to seize illegal and shoddy products.

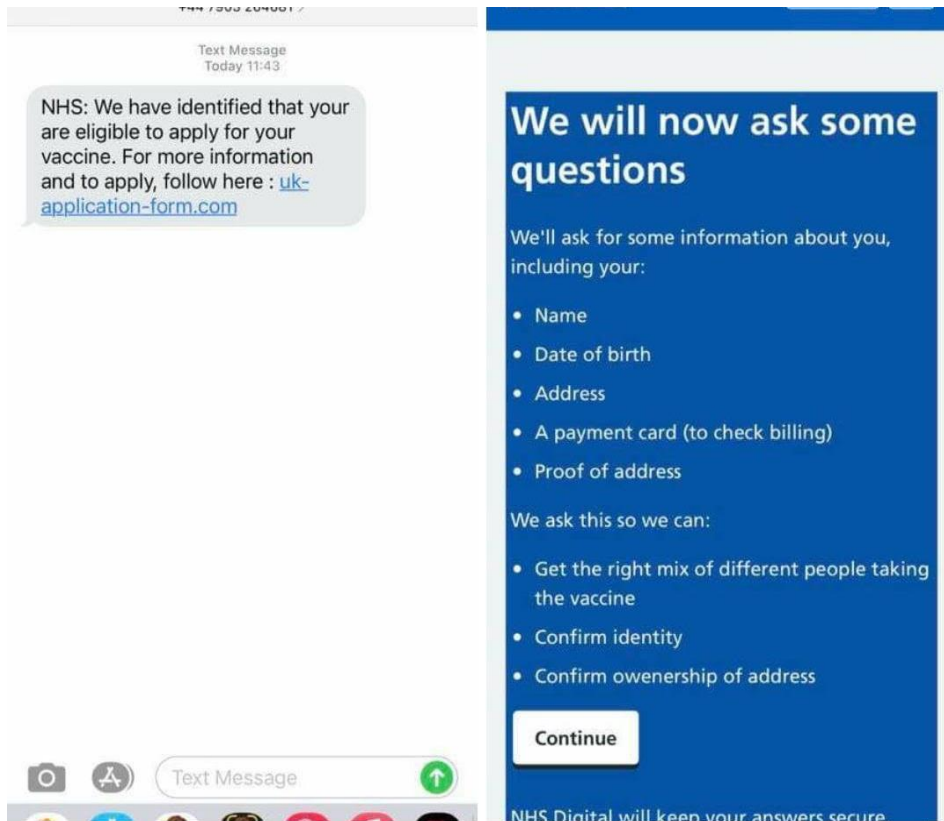

b) DHL

A member has contacted us as they have received an email from DHL but they have not ordered any parcels. Instead of the normal DHL mail address it came from maureenbroo54@gmail.com. Please be aware and see below:

----- Original Message -----

From: DHL <maureenbroo54@gmail.com>

Date: 29 December 2020 at 18:49

Subject: Re: December 29th - Please confirm receipt BhLq

HAPPY NEW YEAR!
CONFIRM TO PROCEED WITH THE DELIVERY

The package n-CA8956783 is waiting to be delivered

DHL

EXPRESS

Hello

The delivery of your parcel N°CA8956783 has been waiting for validation since the 12/21/2020.

To go on with the delivery, just confirm your contact details.







CLICK HERE

TO PROCEED WITH THE DELIVERY





Best regards,
Express delivery services



DHL is not the sponsor nor the organizer of this sweepstake.

c) Nottingham Knockers

Please be aware that we have had doorstep sellers knocking on our doors in our area, selling tea towels and other homewares from a bag. Please do not buy anything from these sellers and if you have elderly friends, relatives, or neighbours, it's important to keep a lookout for them too and report any suspicious activity to police.

So who and what are the Nottingham Knockers?

Nottingham Knockers are doorstep callers who offer a selection of household products for sale. The scam is believed to have originated in Nottingham, hence the name.

The callers are often ex-convicts who claim to be part of a rehabilitation scheme which probably doesn't exist.

How does the scam work?

The scammer buys a bag of goods off the person who employs them, and are allowed to keep anything they make above this price.

Callers offer householders the goods, at inflated prices, but often use the sale as a ruse for checking out a person's home and gullibility.

Many people will buy something and pay them just to get rid of them, but once the money has been handed over, the scam can really begin.

Once the caller gets the money - most often a value that comes to a note - it is examined.

If it is crumpled, they accept it and move on. If it is crisp, flat and new – they are much more interested and engage the person in more conversation, to find out details about them.

The caller also smells the note as they leave. If it is slightly musty, it is an indication there may be more in the property. Those addresses are noted and sold to interested parties in prisons, pubs and among certain trades.

Unfortunately the elderly are often targeted for these scams, and any suspicious activity should be reported to the police.

d) National Insurance Number

A member received a telephone call from 07490181915. When answered a recorded message said her National Insurance number had been compromised and she had to press (1) to deal with this fraud. She simply cancelled the call which the member believes is a scam.

e) Royal Mail

Another member received this email at 9.30am from supposedly Royal Mail. He got suspicious because the Royal Mail never deliver anything by 9.30am, so he contacted Royal Mail who confirmed it was a scam.

Please note:- How can he take action **before** the 5th January, if he only received the email **on** the 5th January?! Please be aware.

From: "Royal Mail Group | GB | reference: zgmbbrbko"

<jhqmt2448886azfdjh@voo.be>

Sent: Tuesday, 5 Jan, 21 At 09:30

Subject: We require additional details to attempt re-delivery of this parcel, as the address provided appears to be incomplete

1/5/2021 9:30:07 a.m.

Hi

Due to a lack of complete address information, we have been unable to deliver your parcel number : 129500978867957

We require additional details to attempt re-delivery of this parcel, as the address provided appears to be incomplete.

Please provide the complete information for this address to attempt redelivery.

Currently, your parcel is being stored in our local depot.

However, if action is not taken before 5 January, it will be returned to the original sender.

> [Delivery now](#) <

Fees will apply for any arranged redelivery, the details of which are included in the links above.

If your preference is to pick up your parcel in person, you can do so from our depot at Frogmore Industrial Estate, Acton Ln, Park Royal London NW10 7NQ.

If you'd like to contact us directly, please do not respond to this automated email.

Instead, contact us on our contact form quoting this specific parcel number provided above.

Kind Regards

Royal Mail | Royal Mail Group Ltd

f) BT

A further member has contacted us as she received a recorded message supposedly from BT saying that her account would be closed due to hacking and criminal activity and to press 1 to speak to someone. She didn't press 1 and she is assuming it was a scam. The phone number was 02080344386.

2) Temporary Road Closures

- a) Belton Way West, Belton Way East, Belton Gardens, Belton Bridge, High Street (Leigh On Sea), Chalkwell Esplanade, Western Esplanade, Marine Parade, Eastern Esplanade, Thorpe Esplanade, Ness Road & George Street – 00:00 31st December 2020 - Emergency Suspension due to the Covid 19 Pandemic**

Temporary Prohibition of Traffic, Parking, Waiting, Loading, Unloading & Stopping. Also Suspension of Car Parks, Pay and Display Bays & Blue Badge Holders for All Areas. Emergency Suspension Due To The COVID19 Pandemic

The Council is satisfied that these restrictions are required owing to the danger to the public of gathering or promenading in groups on the affected roads or public open spaces following the advice of the Government of the United Kingdom of Great Britain and Northern Ireland in respect of social distancing during the COVID19 (coronavirus) emergency.

Whilst this notice is in operation, all vehicles will be prohibited from including Blue Badge Holders:

1. Parking, waiting, loading, unloading & stopping in pay & display bays on Belton Way West
2. Parking, waiting, loading, unloading & stopping in pay & display bays on Belton Way East
3. Parking, waiting, loading, unloading & stopping in Belton Gardens North & South car park
4. Parking, waiting, loading, unloading & stopping in the pay & display bays on Belton Bridge
5. Parking, waiting, loading, unloading & stopping in the pay & display bays & car parks in High Street Leigh (Leigh Foundry & Victoria Wharf)
6. Parking, waiting, loading, unloading & stopping in pay & display bays on Chalkwell Esplanade
7. Parking, waiting, loading, unloading & stopping in pay & display bays on Western Esplanade
8. Parking, waiting, loading, unloading & stopping on limited waiting bays on Marine Parade
9. Parking, waiting, loading, unloading & stopping in the pay & display bays & car parks in Fairheads Green Car Park
10. Parking, waiting, loading, unloading & stopping in the pay & display bays & car parks in Seaway carpark
11. Parking, waiting, loading, unloading & stopping in the pay & display bays & car parks in The Gas works Car park
12. Parking, waiting, loading, unloading & stopping in pay & display bays on Eastern Esplanade
13. Parking, waiting, loading, unloading & stopping in pay & display bays on Thorpe Esplanade

14. Parking, waiting, loading, unloading & stopping in the pay & display bays & car parks in Thorpe Esplanade Car Park

15. Parking, waiting, loading, unloading & stopping in the pay & display bays & car parks in Shoebury Common North Car Park (a) 1984 c.27 (b) 1992 No. 1215 (c) S.I. 1996 No. 107 as amended

16. Parking, waiting, loading, unloading & stopping in the pay & display bays & car parks in Shoebury Common South Car Park

17. Parking, waiting, loading, unloading & stopping in pay & display bays & limited waiting bays on Ness Road

18. Parking, waiting, loading, unloading & stopping in the pay & display bays & car parks in Shoebury East Beach Car Park

PLEASE NOTE IF ANY OF THESE ARE LOCATIONS WITH RESIDENTIAL PARKING ALLOWED YOUR PERMITS ARE STILL VAILD

These prohibitions or restrictions came into effect on **00:00 31st December 2020**. This notice will remain in force for a period of 21 Days.

The prohibitions or restrictions will apply only during such time and to such extent as indicated by traffic signs prescribed by the TRAFFIC SIGNS REGULATIONS AND GENERAL DIRECTIONS 2016

Any vehicle waiting in contravention of any restriction/prohibition imposed by this Notice may be issued with a Penalty Charge Notice and removed under the provisions of the Traffic Management Act 2004.

b) Footpath 99 (Cinder Path) Leigh-On-Sea – 31st December 2020 - Temporary Prohibition of Use Emergency Suspension Due to the COVID19 Pandemic Notice.

The Council is satisfied that these restrictions are required owing to the danger to the public of gathering or promenading in groups on the affected roads or public open spaces following the advice of the Government of the United Kingdom of Great Britain and Northern Ireland in respect of social distancing during the COVID19 (coronavirus) emergency.

Whilst this notice is in operation, all pedestrians will be prohibited from:

ACCESSING FOOTPATH 99 (CINDER PATH) FROM CHALKWELL ESPLANADE TO HIGH STREET (OLD LEIGH) THIS ALSO INCLUDES ACCESS FROM GYPSY BRIDGE.

These prohibitions or restrictions come into effect on **31st December 2020**. This notice will remain in force for a period of 21 days.

Whilst this section of Footpath 99 (Cinder Path) is closed, an alternative route for pedestrians will be marked on site and resident's access will be maintained where possible.

Any vehicle waiting in contravention of any restriction/prohibition imposed by this Notice may be issued with a Penalty Charge Notice and removed under the provisions of the Traffic Management Act 2004.

c) Kilworth Avenue, Southend-on-Sea – 7th & 8th January for 2 days – Essential Tree Maintenance Works

To facilitate essential tree maintenance works, they have imposed a temporary prohibition of waiting, loading and unloading.

Whilst this notice is in operation, all vehicles will be prohibited from:

Waiting, loading and unloading at the following locations in Kilworth Avenue:

From the Junction of Hastings Road to the common boundary of Nos 7/9;
Common boundary of Nos 13/15 to the common boundary of Nos 21/23;
Common boundary of Nos 29/31 to the common boundary of Nos 31/33; Common boundary of Nos 35/37 to the junction of Southchurch Avenue;

From the Junction of Hastings Road to the common boundary of Nos 10/12;
Common boundary of Nos 18/20 to the junction of Cromer Road;

From the Junction of Cromer Road to the common boundary of Nos 32/34;
Common boundary of Nos 40/42 to the common boundary of Nos 44/46

These prohibitions or restrictions will come into effect on **7th & 8th January 2021 for 2 days**. This notice will remain in force for 5 days, to allow for unexpected events/delays and possible remedial works. Access for residents will be maintained where possible.

d) Bournemouth Park Road & Eastern Avenue, Southend-on-Sea – 11th January 2021 - Junction improvement works at Bournemouth Park Road/A1159 Eastern Avenue.

Effect of the order:

To Prohibit Traffic from entering Bournemouth Park Road from its junction with Royston Avenue to its junction with A1159 Eastern Avenue and vice versa;

and A1159 Eastern Avenue from the Roundabout at the junction with Sutton Road to the roundabout at its junction with Fossetts Way and vice versa.

To Prohibit Traffic Turning Left and Right Southbound from A1159 Eastern Avenue into Bournemouth Park Road and Northbound from Royston Avenue into Bournemouth Park Road.

The closures are scheduled to commence from **11th January 2021** or where appropriate signs are showing and weather permitting.

Whilst the works take place a diversion route will be signed on site for Bournemouth Park Road via Royston Avenue, Sutton Road to its junction at the Roundabout at A1159 Eastern Avenue;

and For A1159 Eastern Avenue eastbound from roundabout at the junction with Sutton Road, northwards along Sutton Road, Fossetts Way to the roundabout at the junction with A1159 Eastern Avenue westbound from roundabout at the junction of Fossetts Way, Sutton Road to roundabout at junction with A1159 Eastern Avenue/Sutton Road

Residents Access will be maintained where possible. The closure is required for the junction improvement works at Bournemouth Park Road/A1159 Eastern Avenue.

3) List of Applications Registered **Week Ending 24th December 2020**

Application Number: 20/02152/FULH **Ward: Southchurch**
Officer: Oliver Hart
Erect first floor side extension and install mono pitched roof over existing rear projection
178 Shoebury Road Thorpe Bay Essex

Application Number: 20/02153/FULH **Ward: Southchurch**
Officer: Kara Elliott
Erect first floor front extension and single storey side and rear extensions, extend and alter roof to form pitched roof to front and rear elevations, flat roof dormers to front, side and rear elevations, juliet balconies to front and rear elevations, relocate entrance door at front and alterations to elevations.
19 Ladram Way Thorpe Bay Essex

Application Number: 20/02172/FULH **Ward: Southchurch**
Officer: Hayley Thompson
Erect first floor side extension with balcony to rear and convert garage into habitable accommodation
5 Willingale Way Thorpe Bay Essex

Application Number: 20/02176/FULH **Ward: Southchurch**
Officer: Kara Elliott
Erect single storey side extension
27 Petworth Gardens Southend-On-Sea Essex

Application Number: 20/02058/EDAS **Ward: Southchurch**
Officer: Oliver Hart
Erect additional floor to existing dwelling (Prior Approval for upwards extension)
66 Willingale Way Thorpe Bay Essex

Application Number: 20/02205/GPDE

Ward: Southchurch

Officer: Oliver Hart

Erect single storey rear extension, projecting 7.65m beyond the existing rear wall of the dwelling, 2.70m high to eaves and with a maximum height of 3.0m

99 Burllescoombe Road Thorpe Bay Essex

Application Number: 20/02133/FULH

Ward: Thorpe

Officer: Julie Ramsey

Erect detached double garage to front (Amended Proposal)

1 Colbert Avenue Thorpe Bay Essex

Application Number: 20/02134/FULH

Ward: Thorpe

Officer: Oliver Hart

Erect single storey rear extension

84 Parkanaur Avenue Thorpe Bay Essex

Application Number: 20/02135/CLP

Ward: Thorpe

Officer: Oliver Hart

Hipped to gable roof extension to rear and dormers to sides to form habitable accommodation in the loft space (certificate of lawful development - proposed)

84 Parkanaur Avenue Thorpe Bay Essex

Application Number: 20/02136/FUL

Ward: Thorpe

Officer: Scott Davison

Alter shopfront to incorporate new access door to upper floors and alter elevation to rear to form new access

161 - 163 The Broadway Thorpe Bay Essex

Application Number: 20/02137/FULH

Ward: Thorpe

Officer: Kara Elliott

Erect single storey side and rear extension

11 Woodgrange Close Thorpe Bay Essex

Application Number: 20/02141/CLP

Ward: Thorpe

Officer: Oliver Hart

Single storey rear extension, dormer to rear to form habitable accommodation in roof space, two outbuildings to rear (Lawful development certificate-proposed)

183 Maplin Way Thorpe Bay Essex

Application Number: 20/02143/FULH

Ward: Thorpe

Officer: Oliver Hart

Hip to half hip roof extension and erect dormers to front and rear elevations

(Amended proposal)

134 Parkanaur Avenue Thorpe Bay Essex

Application Number: 20/02154/FULH

Ward: Thorpe

Officer: Kara Elliott

Erect first floor side extension

16 Walton Road Thorpe Bay Essex

Application Number: 20/02163/FULH
Officer: Oliver Hart
Erect single storey rear extension with roof lantern
116 Kensington Road Southend-On-Sea Essex

Ward: Thorpe

Application Number: 20/02147/FULH
Officer: Julie Ramsey
Erect single storey side extension
9 Appledore Shoeburyness Essex

Ward: West Shoebury

Application Number: 20/02148/CLP
Officer: Julie Ramsey
Install dormer to rear to form habitable accommodation in the loft space, erect single storey rear extension and install rooflights to front (certificate of lawful development - proposed)
9 Appledore Shoeburyness Essex

Ward: West Shoebury

List of Applications Registered **Week Ending 31st December 2020**

Application Number: 20/02120/FULH
Officer: Julie Ramsey
Erect first floor rear extension
555 Woodgrange Drive Southend-On-Sea Essex

Ward: Thorpe

Application Number: 20/02132/FULH
Officer: Janine Rowley
Erect first floor side extension, single storey rear extension and alter elevations
30 Buckland Shoeburyness Essex

Ward: West Shoebury

Application Number: 20/02186/FULH
Officer: Julie Ramsey
Erect single storey rear extension
8 Teignrace Shoeburyness Southend-On-Sea

Ward: West Shoebury

4) List of Decisions Issued **Week Ending 27th December 2020**

APPLN. NO: 19/01991/AD
Officer: Oliver Hart
APPLICATION FOR APPROVAL OF DETAILS PURSUANT TO CONDITION 04 (DETAILS OF REFUSE COLLECTION STORAGE FACILITIES) OF PLANNING PERMISSION 17/00467/FUL DATED 23.06.2017
793 SOUTHCHURCH ROAD SOUTHEND-ON-SEA ESSEX
Decision: Grant Permission Date

Ward. Southchurch

APPLN. NO: 20/01812/FULH

Ward. Southchurch

Officer: Spyros Mouratidis

REPLACE CONSERVATORY WITH SINGLE STOREY REAR EXTENSION WITH ROOF LANTERNS

WINDYRIDGE REBELS LANE SOUTHEND-ON-SEA

Decision: Grant Conditional Permission

APPLN. NO: 20/01839/FULH

Ward. Southchurch

Officer: Abbie Greenwood

ERECT SINGLE STOREY REAR EXTENSION, ERECT FIRST FLOOR SIDE EXTENSION AND PART CONVERT GARAGE INTO HABITABLE ACCOMMODATION

21 WANSELL GARDENS THORPE BAY ESSEX

Decision: Grant Conditional Permission

APPLN. NO: 20/01657/FUL

Ward. Thorpe

Officer: Robert Lilburn

ERECT FIRST FLOOR EXTENSION TO REAR

187E BROADWAY THORPE BAY ESSEX

Decision: Refuse Permission

List of Decisions Issued **Week Ending 3rd January 2021**

APPLN. NO: 20/01817/FULH

Ward. Southchurch

Officer: Julie Ramsey

ERECT TWO STOREY REAR AND SIDE EXTENSIONS, ERECT FIRST FLOOR EXTENSION OVER EXISTING PORCH TO FRONT, ROOF EXTENSION TO REAR AND DORMER TO SIDE TO FORM HABITABLE ACCOMMODATION IN THE LOFTSPACE

52 DAINES WAY THORPE BAY ESSEX

Decision: Refuse Permission

APPLN. NO: 20/01857/FULH

Ward. Southchurch

Officer: Julie Ramsey

ERECT TWO STOREY REAR EXTENSION, PORCH AND FIRST FLOOR FRONT EXTENSION WITH DORMER, INSTALL JULIETTE BALCONY TO REAR, ALTER ELEVATIONS (AMENDED PROPOSAL)

218 SHOE BURY ROAD THORPE BAY ESSEX

Decision: Refuse Permission

APPLN. NO: 20/01459/CLE

Ward. Thorpe

Officer: Spyros Mouratidis

SIDE/REAR EXTENSION (LAWFUL DEVELOPMENT CERTIFICATE-EXISTING)

FLAT LOWER 27 WARWICK ROAD THORPE BAY

Decision: Grant Lawful Dev Certificate (Existing)

APPLN. NO: 20/02028/NON

Ward. Thorpe

Officer: Scott Davison

EXTEND DEVELOPMENT UP TO REAR FENCE LINE KEEPING WITHIN 400MM OF THE BOUNDARY AND RAISE THE OVERALL HEIGHT FROM 3.25 TO 3.8M (NON-MATERIAL AMENDMENT TO PLANNING PERMISSION 20/00556/FULH DATED 14.09.2020)

176 BURGESS ROAD THORPE BAY ESSEX

Decision: Refuse Non Material Amendment

5) Coronavirus Information

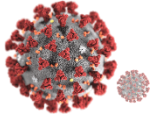

Stay at home: national lockdown

National lockdown restrictions now apply. Please stay at home.

Central Government has announced a national lockdown to help control the virus. We must all stay at home, similarly to March 2020, and only leave for specific reasons (below).

What is the situation locally?

Cases locally are high (960 per 100,000), so we must all work together and stick to the rules to help bring this down, and support our local healthcare workers.

What do we need to do?

You must not leave, or be outside of your home except where necessary. You may leave the home to:

- shop for basic necessities, for you or a vulnerable person
- go to work, or provide voluntary or charitable services, if you cannot reasonably do so from home
- exercise with your household (or support bubble) or one other person, this should be limited to once per day, and you should not travel outside your local area.
- meet your support bubble or childcare bubble where necessary, but only if you are legally permitted to form one
- seek medical assistance or avoid injury, illness or risk of harm (including domestic abuse)
- attend education or childcare - for those eligible

Colleges, primary and secondary schools will remain open only for vulnerable children and the children of critical workers. All other children will learn remotely until February half term. Early Years settings remain open.

Higher Education provision will remain online until mid February for all except future critical worker courses.

Full restrictions are on the Gov website

For information on how to get a COVID-19 test, please see Southend Borough Councils website

Please do not take risks. Please follow the rules and help us all stay safe. Stay at home, protect the NHS, save lives.

Do you need support?

Please don't feel alone.

If you are worried or anxious about the lockdown, please reach out. There are people and friendly organisations who can help.

If you need support with groceries or medication and have no local friends or family to help, please get in touch.

How to get a Coronavirus test

Anyone who has symptoms of coronavirus should apply for the test straight away, but we are also offering a test for anyone who wants one, even without symptoms.

New lockdown for England expected to last until mid-February

Everyone in England must stay at home except for permitted reasons during a new coronavirus lockdown expected to last until mid-February, the Prime Minister has announced. All schools and colleges will close to most pupils and switch to remote learning from today (5th), amid surging cases and patient numbers, while Boris Johnson warned the coming weeks would be the "hardest yet". He said those in the

top four priority groups, including all care home residents and their carers, frontline health and social care workers and the clinically extremely vulnerable would receive a first vaccine dose by the middle of next month.

Hospitals at capacity

NHS hospitals are running out of oxygen and are planning to set up tents to deal with the influx of coronavirus patients, medics claim. There were 21,787 patients in hospital with COVID-19 as of Tuesday, with that number on the rise. Doctors fear that they must soon face “horrendous choices” about which COVID-19 patient receives potentially life-saving treatment.

Elderly fall victims having to wait six hours for ambulances dealing with COVID-19 patients

Elderly people who suffer falls are having to wait up to six hours for an ambulance because of increasing COVID-19 pressures, the College of Paramedics has warned. It said the lengthy delays are partly due to paramedics having to prioritise 999 calls from people suffering from coronavirus-related breathing difficulties.

One in eight retired medics successfully returned to NHS

Only one in eight retired medics who applied to return to the NHS front line to help in the coronavirus pandemic have been unsuccessful due to over-complicated steps in the application process. Around 40,000 doctors and nurses applied to return in March and, of the 30,000 who were eligible, only 5,000 had jobs by July due to the requirement to provide 21 pieces of evidence in the application.

New life-saving COVID treatment announced

A new treatment for COVID-19 which can reduce risk of death by 24 per cent has been revealed. The two drugs which are typically used to treat rheumatoid arthritis can also reduce the time spent in hospital by up to 10 days. The Government will issue new guidance on Friday to encourage hospitals to immediately use the treatment across the UK.

‘Pivotal moment’ as Oxford vaccine rollout begins

The first doses of the Oxford-AstraZeneca COVID-19 jab have been given in the UK as it accelerates its vaccination programme, with more than half a million doses ready for use today (4th). It comes as the Prime Minister warned that regional restrictions in England are “probably about to get tougher” to curb rising COVID-19 infections. Latest figures show on Sunday the UK recorded more than 50,000 new confirmed COVID-19 cases for the sixth day in a row. Labour has called for a third national lockdown in England. Meanwhile it is reported that the NHS has said supply of vaccines is the “main barrier” to delivering tens of millions of doses.

82-year-old first to receive Oxford Covid vaccine

Dialysis patient Brian Pinker, 82, has become the first person to receive the Oxford-AstraZeneca coronavirus vaccine. Health and Social Care Secretary Matt Hancock said it was a “pivotal moment” in the UK’s fight against the virus, as vaccines will help curb infections and then allow restrictions to be lifted.

Oxford vaccine rolled out to hundreds of GP sites in England

The Oxford-AstraZeneca COVID-19 vaccine will be rolled out to GP-run vaccination sites in local communities in England today, with the aim of offering jabs to most care home residents by the end of January. By mid-February, the target is to vaccinate 13 million people in the top four priority groups. More than 700 local vaccination sites will administer the jabs, while another 180 GP-led sites, 100 new hospital sites and a pilot scheme involving local pharmacies will open this week.

15 million vaccines in five weeks

Hundreds of thousands of vaccines will be delivered daily by next week, with 15 million of the most vulnerable being offered the jab by Monday 15 February, the Prime Minister has announced. A new national booking service will be launched to make it easier to book an appointment at one of the 1000 GP-led sites, 223 hospital sites, seven large vaccination centres or 200 pharmacies set up to administer the vaccine.

Experts call for vaccination target to double

The UK must double its vaccination target to two million a week in order to avoid a third wave of the coronavirus, the London School of Hygiene and Tropical Medicine has recommended in a paper shared with the Government's Scientific Advisory Group for Emergencies (SAGE).

12-week vaccine gap defended by UK medical chiefs

The UK will give both parts of the Oxford and Pfizer vaccines 12 weeks apart, having originally planned to leave 21 days between the Pfizer jabs. The British Medical Association said cancelling patients booked in for their second doses was "grossly unfair" but chief medical officers said getting more people vaccinated with the first jab "is much more preferable".

UK scientists trial drug to prevent infection that leads to COVID-19

UK scientists are trialling a new drug that could prevent someone who has been exposed to coronavirus from going on to develop the disease COVID-19, which experts say could save numerous lives. The antibody therapy would confer instant immunity against the disease and could be given as an emergency treatment to hospital inpatients and care home residents to help contain outbreaks.

International travellers to require negative test

All passengers arriving in England from international destinations will need to present a negative test before entry from next week. The test will need to be taken by those arriving by boat, plane and train within 72 hours of departure and failure to comply will result in a £500 fine. Even with a negative result, those arriving from countries not on the Government's travel corridor list will still need to self-isolate for 10 days.

Weekly Briefing on Local Decisions & Actions re Coronavirus outbreak 31st December 2020

Key updates/actions

- **Essex Resilience Forum declared a major incident on Tuesday 29 December 2020, due to pressures on our health and care system.**

We continue to work with our partners in health to support work to reduce hospital admissions and increase capacity to support more hospital discharges.

This includes encouraging the public to follow the Government's Tier 4 Guidance "Stay at Home" and to remember "Hands. Face. Space" particularly over the New Year period.

- **Measures in place to protect lives.**
To help ensure the public follow the Government's Tier 4 Guidance "Stay at Home":
 - We have closed all seafront car parks with immediate effect
 - We have closed the cinder path between Chalkwell and Old Leigh
 - The Public Space Protection Order (PSPO) already in place in the Town Centre, Hamlet Court Road and the seafront, will be enforced more rigorously. This is to deter public drinking and other anti-social behaviour.

Following a number of enquiries, we can confirm that public toilets will remain open.

- **Delayed school return.**

All schools will re-open on Monday 4 January 2021, but following yesterday's Government announcement, only for vulnerable children and those of critical workers.

The majority of primary and secondary school children will not return to the classroom until Monday 18 January 2021. Instead, children will be taught at home via online classes or home education packs.

All year 11 and year 13 students will be expected to return to school on Monday 11 January 2021.

Head teachers will receive a letter today asking them to urge parents and families to take part in the community testing pilot, before they return to school to help stop the spread of the virus. The letter includes details of where and how parents can book tests.

- **Delayed waste collections.**

Waste collection crews are working hard to collect a much higher amount of waste being presented due to the Christmas period and as part of the continuing impact of increased recycling and waste that has been seen throughout the pandemic. Extra resources were put in place to help deal with an expected additional demand, but a small number of waste collection staff are self-isolating in line with Government guidance. Any roads not collected on their revised day are being prioritised the following morning.

- **Approval of the Oxford Vaccine.**

We are expecting delivery of the Oxford vaccine to the Borough in the coming days. The roll-out of the vaccine is being led by Southend CCG and Primary Care Networks and details of distribution are yet to be confirmed. It is expected that the vaccine will be made available to the hospitals first and then to our local Primary Care Networks during the second week of January. Those eligible for the vaccines are being called up through their general practices. As soon as we get further information, we will update through this Weekly Briefing.

- **Southend-on-Sea continues Tier 4 ‘Stay at Home’ restrictions.**

Please help us spread the message “Hands. Face. Space” and to stay at home wherever possible.

- **Local support is in place over winter.**

Please see Livewell Southend website for more details of local support in place.

- **COVID-19 testing ‘collect and drop off point’:**

The COVID-19 testing ‘collect and drop off’ point in Leigh-on-Sea for people without symptoms remains closed. Other testing sites are at Hamlet Court Road, Short Street and Southend Airport.

- **COVID-19 pulse survey.**

The Council is asking residents to let it know about their experiences during the COVID-19 pandemic and what steps they think the borough can take to ensure a positive future.

- **Coronavirus case data.**

This is published on our website and now also includes the daily 7 day rate of positive cases per 100,000. Some of the data from that page has been pulled out and is below:

- **7-day rate** of positive cases as of **31 December**

- 2020** was **968.2** per **100,000** (up from 937.1 per 100,000 on Thursday 24 December). The rate in the **60 and over age bracket** is **659.5** per **100,000**, up from 560.6 per 100,000 on 24 December.

- **ONS death data:** Southend-on-Sea residents’ deaths registered inside and outside of Southend-on-Sea with any mention of COVID-19 on the death certificate that occurred up to 18 December 2020 but were registered up to 26 December 2020: **264 (+17)**.

- **National and local data:.**

The national NHS Digital information shows information by time intervals (for example, 3-days, 7-days, 30-days, etc), as well as the total numbers and requests or referrals to NHS 111.

Other

- Members of the public who need to self-isolate but are stuck and have no local support from friends and family can call the helpline on 01702 212497. A full list of support contact numbers is available on the corporate website

- **Out of hours**

Out of hours:

Urgent issues arising out of hours should be reported to the out of hours service in accordance with standard practice.

The phone number is 01702 215000.

The out of hours service will then contact the relevant Council officer who is on-call or the relevant contractor such as Veolia.

They also have access to the town link radio and CCTV.

Summary of Covid-19 related Government announcements 4th and 5th January 2021

The PM held two press briefings this week:

4 January – full press briefing

- England enters a new national lockdown. People must stay at home except for specific reasons allowed under law, such as essential shopping and going to work.
- The number of Covid patients increased by almost a third last week, putting great pressure on hospitals.
- The government will advise those clinically extremely vulnerable people who previously shielded to do so again.
- Schools will move to remote learning from 5 January, except for vulnerable children and key worker children. However, nurseries will still be accessible.
- School closures for most pupils might mean it is "not possible or fair" for all exams to happen this summer "as normal". The education secretary and Ofqual will put in place alternative arrangements.
- If the vaccine roll-out continues to be "successful", deaths begin to fall, and people follow the rules, the PM said he hoped we can "steadily move out of lockdown, reopening schools after half term and starting, cautiously" to move regions down England's tiered system of restrictions.

HM Treasury

- In the Chancellor's announcement today, businesses in retail, hospitality and leisure sectors will receive a grant up to £9k. An additional £594k discretionary fund, to be allocated by LAs, will support other businesses not eligible for the grant.

HM Revenue and Customs

- The Coronavirus Job Retention Scheme guidance is updated now includes information for those with caring responsibilities. These individuals are those who care for a vulnerable individual in your household, or children who are home as a result of school/childcare facilities closing.

PHE

- In a press release, the first people have received the Oxford University/AstraZeneca coronavirus vaccine (4 January) as the vaccination programme is expanded across the UK.
- A joint statement is released from the UK Chief Medical Officers (CMOs) recommending that the UK COVID-19 alert level move from level 4 to level 5.
- In a press release, An England-wide survey found that 80% of people aged 18+ have made the decision to change their lifestyle in 2021.
- A series of stay at home posters are released displaying information about the National Lockdown in England.

5 January

- 60,000 confirmed COVID-19 cases were reported today - the highest recorded daily figure.
- Numbers in hospitals are 40% higher than in April.
- 1.1m people have now been vaccinated in England, including 650,000 aged 80+.
- The PM will be delivering daily vaccine updates from Monday.
- If "things go well", by February 15 2021, the NHS is committed to have offered a first Covid vaccine dose to everyone in the four top priority groups –
 - Care home residents and their carers,
 - Everyone aged 70 and over,
 - Frontline health and social care workers,
 - The clinically extremely vulnerable.

Summary of Covid-19 related Government announcements 6th January 2021

The new lockdown regulations have been published along with an explanatory memorandum and new guidance:

- Regulations: <https://www.legislation.gov.uk/uksi/2021/8/made>
- Explanatory memorandum: https://www.legislation.gov.uk/uksi/2021/8/pdfs/uksiem_20210008_en.pdf
- Guidance: <https://www.gov.uk/guidance/national-lockdown-stay-at-home>

The **Education Secretary** has outlined several changes impacting on schools:

- Ofqual will launch a consultation on options for alternatives to exams. The expectation is that teacher assessments will be used.
- Families entitled to free school meals will also be offered food parcels or vouchers.
- Schools and colleges can continue with the vocational and technical exams that are due to take place in January, where they judge it right to do so.

DfE has also confirmed:

- Critical Workers - That children with at least one parent or carer who is listed as a critical worker are eligible for a school place. It is not necessary for both parents to be critical workers. An updated list of critical workers has been published.
- Technology & devices - All secondary schools have been invited to order tablets for disadvantaged children.
- Gov will invite primary schools to order devices starting with the most disadvantaged areas first.
 - o Order laptops: <https://get-help-with-tech.education.gov.uk/start>
 - o Get internet access: <https://get-help-with-tech.education.gov.uk/internet-access>
- DfE can also help councils set up a digital education platform (Google for Education or Microsoft 365 for Education) for free, if needed.
- Testing - All schools with secondary-age pupils, will receive an initial delivery of lateral flow device test kits to support asymptomatic testing from the start of the spring term.
- Schools and colleges do not need to complete the educational setting status form from today

Guidance has been updated for:

- managing council buildings - it signposts to relevant guidance on a range of different activities that can take place in these buildings during the national lockdown
- Providers of supported living settings.

Summary of Covid-19 related Government announcements 7th January 2021

Department of Health and Social Care has published:

- Updated guidance for providers of supported living settings to reference the new national lockdown
- Updated guidance on shielding: clinically extremely vulnerable people should now shield at home. Information for those providing personal care to people living in their own home
- New oral statement to Parliament by the Secretary of State for Health and Social Care on the new regulations following the move to a national lockdown.

DWP has published:

- New national COVID-19 measures to protect the NHS and save lives. ensure essential support is provided whilst keeping colleagues and customers safe. These include:
- Jobcentres will remain open, as they have throughout this pandemic, to provide essential services and support to those who we cannot help in any other way.
- We will ensure that this support continues to be delivered in line with the latest government and PHE guidance – such as maintaining social distancing and rigorous cleaning regimes - keeping our colleagues and customers safe.
- Work Coaches will be empowered to support customers through the best and most appropriate channels - whether online, by phone, or in person - with jobcentres remaining open to help those who need extra support and are unable to interact with us on the phone or digitally.
- Our Work Coaches will continue to deliver employment support programmes such as the Job Entry Targeted Support (JETs) scheme, by phone or through online channels.
- Face-to-face assessments for disability benefits remain suspended.
- If you think you might be entitled to a health and disability benefit, you should contact us as soon as possible to make a claim in the usual way.
- For existing customers, payments will continue as normal. Anyone who has a change in their needs should contact us immediately so we can ensure they are receiving the correct level of support.

MHCLG has published:

- Updated guidance for those managing council buildings. It signposts to relevant guidance on a range of different activities that can take place in these buildings.
- Updated guidance for owners and operators of playgrounds and outdoor gyms to enable their use while minimising the transmission risk.
- Updated guidance for the owners and operators of beach, countryside and coastal destinations.

HM Courts and Tribunals Service has published:

- Updated advice and guidance for all court and tribunal users and will be updated when new advice is available.

Maritime and Coastguard Agency has published:

- Updated advice about visiting your local coastline - please take care and follow the rules and social distancing guidelines according to the guidance for your area.

Department for Digital, Culture, Media & Sport has published:

- Updated guidance covering national restrictions in England from 6 January. This guidance sets out information for the public and sport providers on how to participate in grassroots sport and physical activity during COVID restrictions.

DfE has published:

- New guidance pupils to receive set number of hours of remote education each day and Ofsted to inspect where it has concerns

Home Office has published:

- Updated advice for visa customers and applicants in the UK, visa customers outside of the UK and British nationals overseas who need to apply for a passport affected by travel restrictions. Added information on Occupational Structured Clinical Examination deadline extension.

- END -